

## R-ITS-Z Internally Threaded Sockets

High load-bearing capacity

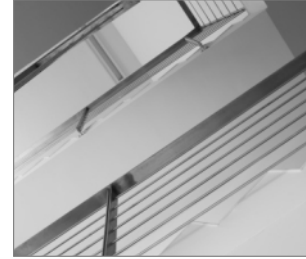
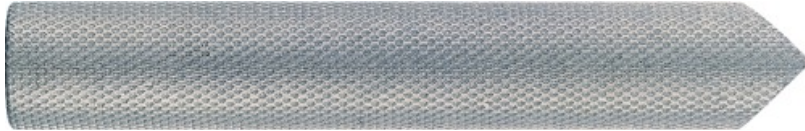

### Product information

#### Features and benefits

- Allows removal of bolt to leave a re-usable socket in place
- High load-bearing capacity
- Close edge and spacing distances
- Expansion free functioning
- Available in zinc plated and stainless steel versions

#### Applications

- For fastening bolts
- Safety barriers
- Temporary works/formworks support systems

#### Base materials

##### Approved for use in:

- Non-cracked concrete C20/25-C50/60

### Installation guide



1. After injecting resin, immediately insert the socket anchor, slowly and with a slight twisting motion until flush with surface
2. Remove excess resin, then leave anchorage undisturbed until curing time has elapsed
3. Fill hole with the required resin to the recommended fill level. (Follow the relevant instructions for the resin product)
4. [English]: Powoli włożyć tuleję do otworu z żywicą do osiągnięcia zalecanej głębokości kotwienia.
5. [English]: Pozostawić do zastygnięcia na wymagany dla aplikacji okres czasu.
6. Attach fixture and tighten the nut to the required torque.
7. After injecting resin, immediately insert the socket anchor, slowly and with a slight twisting motion until flush with surface
8. For installation with a drilling machine, insert the setting tool into socket and spin in using rotary hammer action
9. Remove excess resin, then leave anchorage undisturbed until curing time has elapsed

Product information

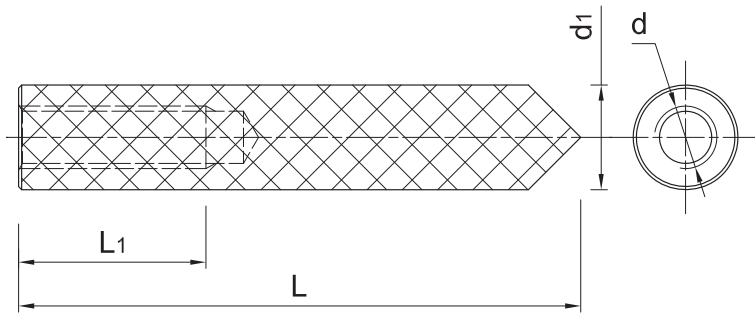

| Size | Product Code  | Anchor          |        |                        | Fixture                       |               |
|------|---------------|-----------------|--------|------------------------|-------------------------------|---------------|
|      |               | Socket diameter | Length | Internal thread length | Max. thickness $t_{fix}$ for: | Hole diameter |
|      |               | $d$             | $L$    | $l_g$                  | $h_{nom, std}$                | $d_f$         |
|      |               | [mm]            | [mm]   | [mm]                   | [mm]                          | [mm]          |
| M6   | R-ITS-Z-06075 | 10              | 75     | 24                     | -                             | 7             |
| M8   | R-ITS-Z-08075 | 12              | 75     | 25                     | -                             | 9             |
|      | R-ITS-Z-08090 | 12              | 90     | 25                     | -                             | 9             |
| M10  | R-ITS-Z-10075 | 16              | 75     | 30                     | -                             | 12            |
|      | R-ITS-Z-10100 | 16              | 100    | 30                     | -                             | 12            |
| M12  | R-ITS-Z-12100 | 16              | 100    | 35                     | -                             | 14            |
| M16  | R-ITS-Z-16125 | 24              | 125    | 50                     | -                             | 18            |

Product commercial data

| Size | Product Code  | Anchor      | Quantity [pcs] |       |        | Weight [kg] |       |        | Bar Codes     |
|------|---------------|-------------|----------------|-------|--------|-------------|-------|--------|---------------|
|      |               | Length [mm] | Box            | Outer | Pallet | Box         | Outer | Pallet |               |
| M6   | R-ITS-Z-06075 | 75          | 10             | 10    | 5600   | 0.41        | 0.41  | 260.7  | 5010445606205 |
| M8   | R-ITS-Z-08075 | 75          | 10             | 10    | 5600   | 0.65        | 0.65  | 394.0  | 5906675087719 |
|      | R-ITS-Z-08090 | 90          | 10             | 160   | 5600   | 0.70        | 11.2  | 422.0  | 5010445606236 |
| M10  | R-ITS-Z-10075 | 75          | 10             | 10    | 5600   | 0.77        | 0.77  | 461.2  | 5010445606243 |
|      | R-ITS-Z-10100 | 100         | 10             | 160   | 3360   | 1.36        | 21.7  | 486.0  | 5010445606267 |
| M12  | R-ITS-Z-12100 | 100         | 6              | 6     | 2016   | 0.69        | 0.69  | 261.8  | 5906675087726 |
| M16  | R-ITS-Z-16125 | 125         | 6              | 6     | 2016   | 2.0         | 2.0   | 699.3  | 5906675087733 |